

SEAM PHANTOM™

INSTRUCTION MANUAL

Model No. 0010-1

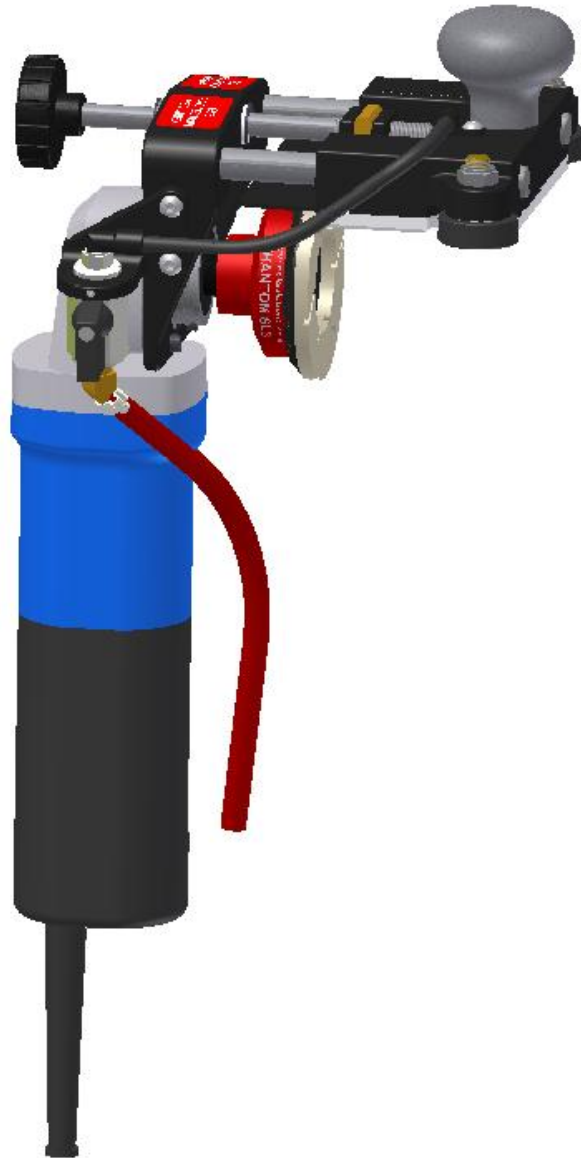

Please read this instruction manual thoroughly to ensure safety and correct use of tool.
Keep this manual in a place where operators can access it easily, anytime when necessary.

INTRODUCTION

Thank you for purchasing the NSI Solutions SEAM PHANTOM™ (Patent Pending). Please read this instruction manual thoroughly for assembly instructions, safe operation, tool handling, tool capabilities information, and all other precautions before using the tool. Keep this manual in a place where operators can access it easily.

In order to be used, the Seam Phantom is assembled to an angle grinder. Observe all of the Operational and Safety instructions contained in the Instruction Manual supplied with the Angle Grinder.

TABLE OF CONTENTS

- INTRODUCTION 2
- GENERAL SAFETY RULES..... 3
- ASSEMBLY 3
 - SEAM PHANTOM Packages and Accessories 3
 - Tools Needed For Assy Of Seam Phantom to Grinder 4
 - Assembly Instructions – Electric Version 4
 - Assembly Instructions – Air Version 7
- USE INSTRUCTIONS 9
 - Before Using the Seam Phantom - Preparations 9
 - How To Operate..... 10
- CLEANING AND MAINTENANCE 12
- CONTACT NSI SOLUTIONS..... 14

GENERAL SAFETY RULES



WARNING: Read and understand all instructions. Failure to follow all instructions listed below, may result in electric shock, fire and/or serious personal injury. Additionally, observe all safety instructions provided with the electric and air tools.

ASSEMBLY

SEAM PHANTOM Packages and Accessories

Package SP-E: Seam Phantom™ Electric Grinder Package Package SP-A: Seam Phantom™ Air Polisher Package	Pkg SP-E	Pkg SP-A
(1) Seam Phantom	•	•
(1) Adapter for Air Tool	Opt	•
(1) Arbor Extension	Opt	•
(1) Splash Guard Angle	•	
Screws Required for Assembly	•	•
(4) Washers (to allow for angling of the grinding head)	•	•
(1) Spray Skirt	•	
(1) Makita 9565CV or 9564CV angle grinder	•	
(1) Center Water Feed Air Polisher (Alpha Air-658, Barranca BD-2321 or equivalent)	Opt	•
(1) 48" Glide Guide Rail	•	•
72" Glide Guide Rail	Opt	Opt
96" Glide Guide Rail	Opt	Opt
(1) Tool Box for Seam Phantom and Attachments	•	Opt
(1) GFCI	•	
(1) Phantom SL3-ADAPT – 5/8-11 Adapter	•	•
(1) Phantom SL3-60 Turbo Pad	•	•
(1) Phantom SL3-150 Turbo Pad	•	•
(1) Phantom SL3-300 Turbo Pad	•	•
(1) Phantom SL3-Cup 2 – 2" Cup Wheel for back grinding	•	•
(2) C-Clamps for clamping Glide Guide	•	•
(2) Gauge Blocks	•	•
(1) Assy and Usage Instruction Manual	•	•

KEY NOTE

- These items supplied with the package as noted.
- Opt These items optional – available separately.

Tools Needed For Assy Of Seam Phantom to Grinder

Electrical Version

3 mm Allen (Hex) Wrench

Alcohol (rubbing) to prepare electric grinder surface for spray skirt installation

Air Version

3/4" Wrench

3/32 Allen (Hex) Wrench

3 mm Allen (Hex) Wrench

Assembly Instructions – Electric Version

CAUTION:

- Always be sure that the tool is switched off and unplugged before carrying out any work on the tool.

1. If installed, remove wheel guard from grinder (See Figure 1). Guard will not be re-installed for use with the Seam Phantom.
2. Using a 3mm Allen or Hex wrench, remove the quantity (4) 4mm diameter Hex screws from head of Grinder at locations as shown in Figure 2. Do not remove the grinding head. Screws can be discarded or saved for future use of grinder without Seam Phantom.

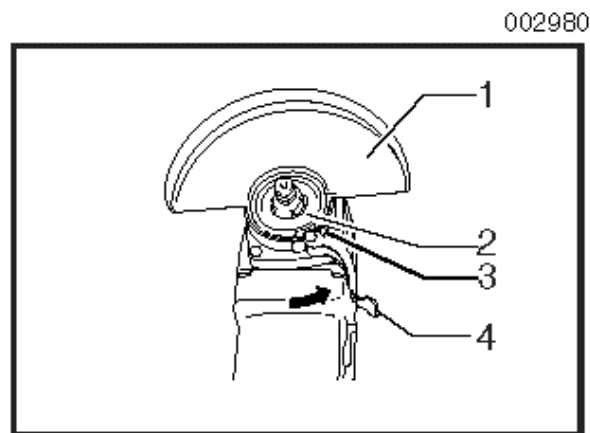

Item 1 – Wheel Guard

FIGURE 1 - Wheel Guard Removal from Grinder

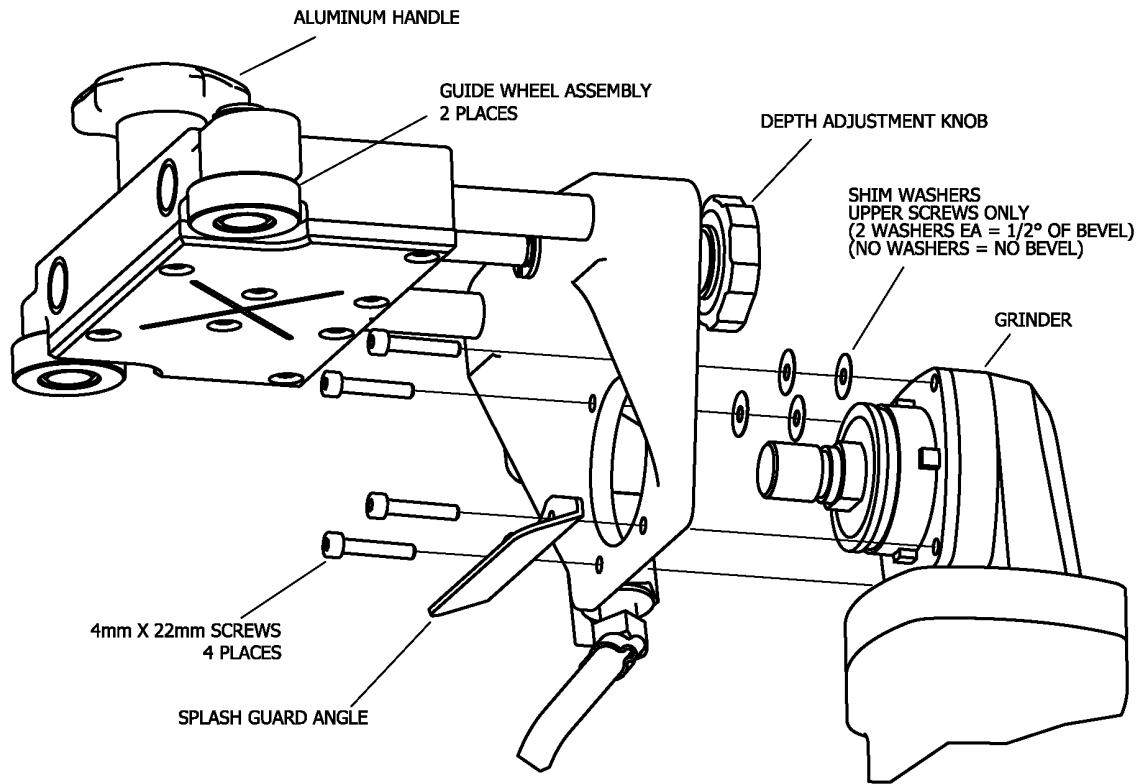

**FIGURE 2 – Assembly Exploded View
(Spray Skirt not shown)**

3. Position Seam Phantom and Splash Guard Angle, and attach to Grinder as shown in Figure 2 using (4) 4mm X 22mm Hex Screws supplied with Seam Phantom. Insert washers (optional) between grinder and Seam Phantom to set grinder pad at desired angle as noted below and in Figure 2. Tighten using a 3mm Allen (Hex) wrench.

NOTE: If wanting to make 90 degree edges, do not use any of the shim washers. If desired, washers can be added to achieve desired bevel or to correct an “out of alignment” condition. Example: Installing (2) ea of the supplied washers per top screw as shown in Figure 2 will result in approximately ½ degree of bevel. Leaving the washers out should result in 0 degree of bevel, or a 90 degree angle for the edge.

4. Install Spray Skirt
 - a) Clean grinder with denatured (rubbing) alcohol prior to installing skirt
 - b) Mark the center of the skirt along the top edge to help center the spray skirt on the grinder
 - c) Install approx. 1/4 inch below the switch as shown
 - d) Tape is extremely sticky - care should be taken once the tape backing is removed
 - e) Skirt must be installed without gaps or wrinkles in the tape to minimize water penetration to the grinder
 - f) Fold back skirt and blow out grinder after each use



FIGURE 3 – Spray Skirt Installation, #1



FIGURE 4 – Spray Skirt Installation, #2



FIGURE 5 – Spray Skirt Installation, #3



FIGURE 6 – Spray Skirt Installation, #4

5. If desired, fasten water supply hose to cord of Grinder using electrical tape or other suitable method.
6. Install Phantom SL3 Adapter or other grinding pads as desired and unit is ready for use.

CAUTION: Ensure electrical circuit supplying grinder is protected by a ground fault circuit interrupter (GFCI).

Assembly Instructions – Air Version

1. Attach the arbor extension to the polisher and tighten appropriately. See Figure 7.

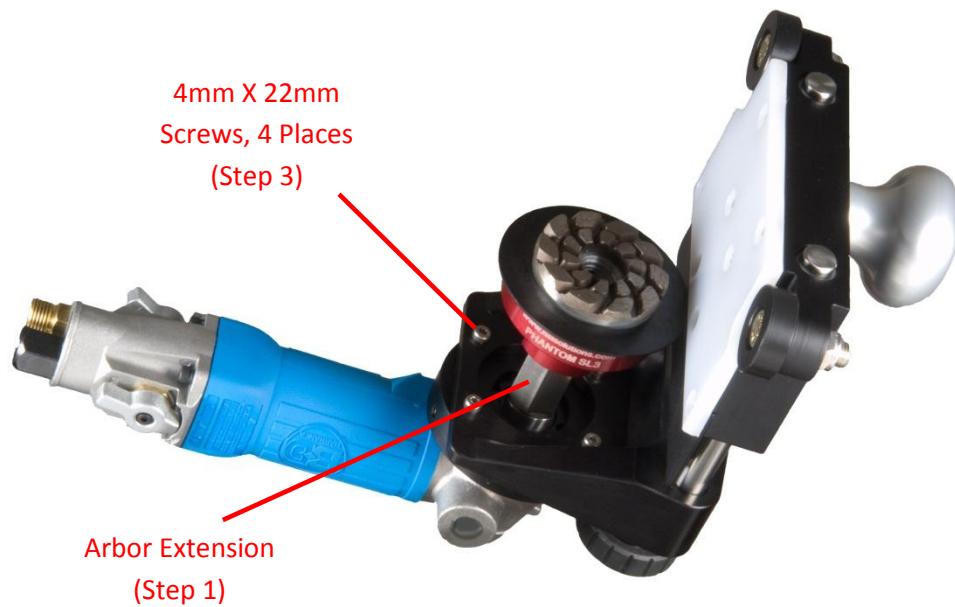

FIGURE 7 – Air Polisher – Arbor Extension

2. Attach the adapter to the polisher as shown in the Figure 8 below. Note the **UP** indicator mark on the adapter, and ensure the polisher is installed in the proper orientation to the adapter. Tighten the (5) set screws using a 3/32 Hex Wrench. Check screws frequently for tightness. If screws loosen with use then apply Loctite 222 (purple) or equivalent and re-tighten.

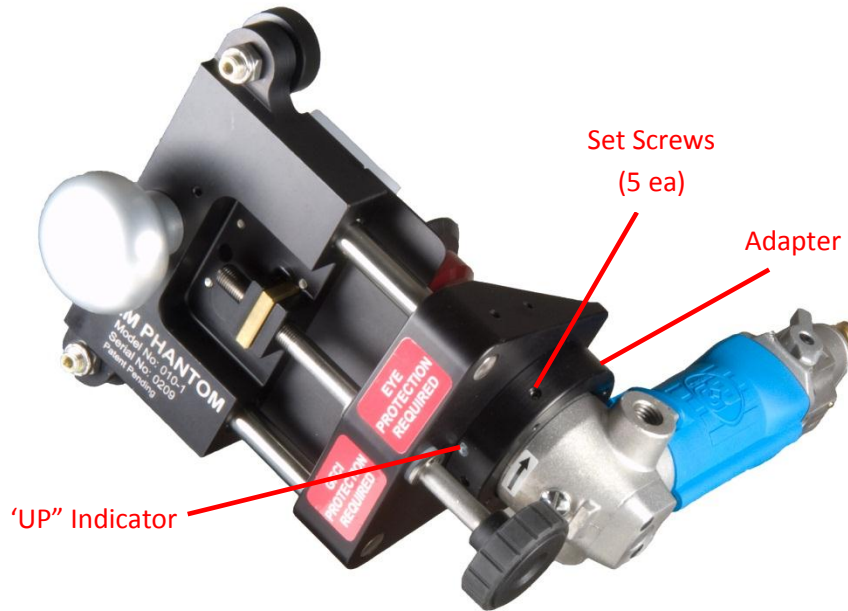

FIGURE 8 – Air Polisher Adapter

3. Attach the polisher, adapter and arbor extension to the rest of the Seam Phantom using (4) 4mm X 22mm Hex Screws (supplied) as shown in Figure 7. Insert shim washers (optional) between adapter and Seam Phantom to set polishing pad at desired angle.

NOTE: If wanting to make 90 degree edges, do not use any of the shim washers. If desired, washers can be added to achieve desired bevel or to correct an out of alignment condition. Example: Installing (2) ea of the supplied washers per top screw as shown in Figure 2 will result in approximately ½ degree of bevel. Leaving the washers out should result in 0 degree of bevel, or a 90 degree angle for the edge.

4. Install Phantom SL3 or other grinding pads as desired and unit is ready for use.

USE INSTRUCTIONS

Before Using the Seam Phantom - Preparations

Before using the assembled Seam Phantom, be sure to complete the following preparations.



1. Supply the specified voltage (electric version)

Supply the voltage specified on the nameplate of the machine. Otherwise damage could result to the machine, or increase the risk of personal injury.



2. Install a Ground Fault Circuit Interrupter (GFCI) (electric version)

WARNING: To prevent electrical shocks, be sure that the power circuit being used is protected by a GFCI device, or be sure to install a ground fault circuit interrupter (GFCI) between the main power supply and the cord of the machine.



3. Ensure Spray Skirt and Shield are installed (electric version)

WARNING: Do not let water into the motor of the electric grinder. Water inside the machine will weaken the electrical insulation of the motor and may result in electric shock. Ensure upper spray shield and lower spray skirt are installed at all times during use .



4. Organize the Work Area for Safe Operation

Before beginning operations, make sure that the work area conditions are well organized for safe operation of the Seam Phantom.



5. Use Proper Safety Gear

To prevent damage to eyes from flying debris, wear protective glasses or face shield.
Be sure to wear waterproof safety boots.

How To Operate

NOTE: If you have access to the Internet, see www.seamphantom.com for links to a video as well as pictures of the process (click on the picture entitled "SEAM PHANTOM PROCESS"). This manual will also be available on the website.

1. Setup

Set your work piece on the work bench and secure it using appropriate clamps. Take care to leave enough overhang for the grinding pad to get all the way to the end of the slab, and for the guide rail clamps to clear the work bench.

NOTE: To allow for removing material, the seam should be "overcut" during the sawing process by as much as the largest chips.

2. Guide Setup

- Using your template or other method, determine final trim line for Seam. Mark with masking tape or other preferred method.
- Use gauge blocks to line up the Glide Guide straight edge. See Figure 9 below.
- Your guide rail should extend a minimum of 3" (7.5 cm) past both sides of the stone. Make sure that you select the correct size guide rail for your work piece.
- Clamp Glide Guide straight edge using appropriate Clamps

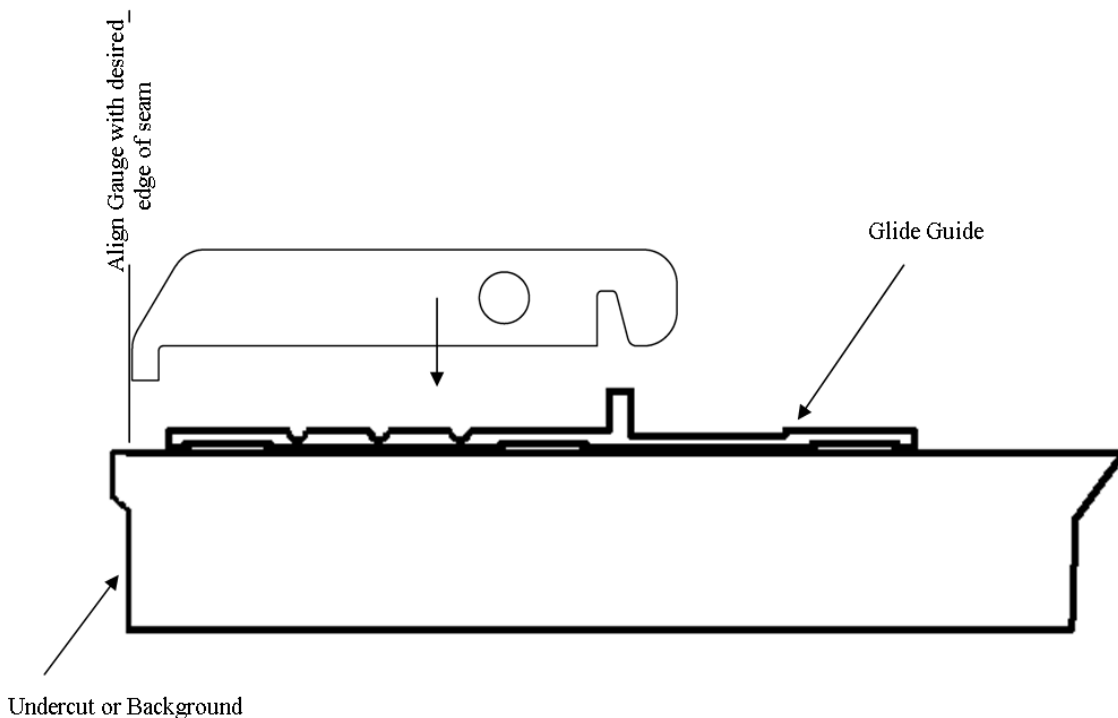

FIGURE 9 – Gauge Block Use

3. Back Grind or “Undercut”

The back grinding is done using the Phantom SL3 2" cup wheel. Ensure adequate water flow is provided by adjusting the valve. Use the 2" cup wheel to grind slightly more material than you'll be dressing off with the turbo pads. Be sure to stop the back grind short of the front "profiled" edge to avoid a large gap in the front edge. This back grind will allow the turbo pads to dress the seam more efficiently and also provide a rough surface for the seaming adhesive to stick to.

Alternatively, the back grind can be done by hand using an appropriate angle grinder and material removing disk.



WARNING: The Phantom SL3 Cup Wheel is made to be used with water. With the electric model, adjust water flow to ensure the water is hitting the “backstop” of the SL3 2” cup wheel and splashes onto the grinding area. With the air model, the water is fed through the center water feed of the polisher. DO NOT OVERHEAT the Cup Wheel by operating it dry. Max speed for the 2” Cup Wheel is 10,000 RPM.

4. Dressing the Seam (Suggested Process)

a) Start with either the SL3 60 or 150 Grit Turbo Pad.

NOTE: The decision will depend on the size of chips in the edge, and how much material is to be removed.

b) Use adjustment knob to back off tool so that grinding pad is not touching the stone.

c) Turn on the power and water. Adjust the water flow by rotating the valve part way.

NOTE: The electric version has the water valve mounted on the Seam Phantom itself. Keep the water volume turned down low to minimize the amount of water that sprays onto the electric grinder.

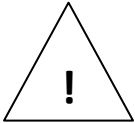

WARNING: Max speed for the The Phantom SL3 Turbo Pads is 4,000 RPM. Do not run at a higher RPM or premature wear or damage can result.

d) Turn adjustment knob clockwise until grinding pad just touches stone and begin grinding the seam.

e) Turn the adjustment knob to gradually cut deeper. Adjust in gradually until the cut is almost to the final marks (stopping short to allow the 300 grit to finish).

NOTE: For best results, only apply pressure to the tool using aluminum handle above the flat surface of the straight edge. Do not apply pressure via the grinder or by pushing on the adjustment knob.

f) Repeat process using 300 Grit Pad. (This is personal preference and depends on the type of material being dressed. You might find that your results from the 150 Grit Pad are sufficient.)

g) Continue until seam is at marked line and no edge chipping. Continuing until pad barely touches stone will ensure a straight and chip free edge.

5. After Use

Clean and dry the electric grinder as noted in the Cleaning and Maintenance section.

CLEANING AND MAINTENANCE



CAUTION:

Always be sure that the tool is switched off and unplugged before attempting to perform inspection or maintenance.

The tool and its air vents have to be kept clean. Regularly clean the tool's air vents or whenever the vents start to become obstructed.

To maintain product SAFETY and RELIABILITY, repairs of the electric or air tools should be done by an Authorized or Factory Service Center.

1. Blow Out Electric Grinder

Fold back spray skirt and blow out grinder vents after each use using a dry air supply to remove any dust or moisture. This will extend the life of the electric motor.

2. Cleaning Guide Rods and Bushings

After heavy use, the in and out adjustment of the Seam Phantom may become stiff. Performing the following steps should correct this. See Figure 10.

- a) Disconnect the water feed hose at the valve end with the quick disconnect tube fitting, by pushing the ring towards the hose fitting.
- b) Extend the adjustment by turning the adjustment screw until the two halves of the Seam Phantom can be separated. Do not lose the square adjustment nut.
- c) Use a paper towel or other soft material and push through the bushing holes, sliding back and forth until all grit is removed.
- d) Using a soft towel or material, wipe the stainless shaft guide rods clean.
- e) Clean screw threads on the adjustment screw.
- f) Reassemble the two halves and re-connect the water hose by pushing it in until it snaps in place.

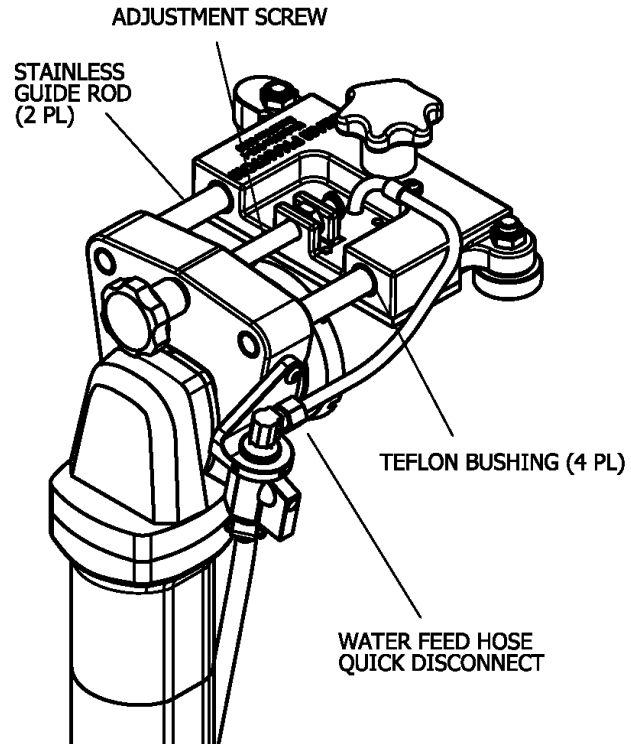

FIGURE 10 – Cleaning (Electric version shown)

3. Air Tool

Perform regular oiling and other maintenance of the air polisher as recommended by the manufacturer.

CONTACT NSI SOLUTIONS

Whether it's for replacement parts, technical or usage support, or just to brag about how tight your seams are, feel free to contact us. If we supplied the electric or air polisher and it failed, please contact the manufacturer direct for warranty replacement or work. The warranty card was supplied with the polisher when it was delivered from us.

Here's how to reach us:

Main Phone: 425-297-3162

Fax: 425-513-2388

Web: www.nsisolutions.com

Email address: info@nsisolutions.com

Mail: 1205 8th DR
Mukilteo, WA 98275

Usage Tips: For usage help and/or tips:
- www.nsisolutions.com and go to the Support Section which includes FAQs, or
- www.stoneadvice.com/forum/ or www.stonefabricatorsalliance.com and either search for "Seam Phantom" or ask your question in an appropriate forum.